



**PEG-E
GAS-FIRED
STEAM BOILERS**

NEAR BOILER PIPING



Manufactured by:
ECR International Inc.
2201 Dwyer Avenue, Utica, NY 13501
Tel. 800 253 7900
www.ecrinternational.com
PN 615000211 REV. B [05/24/2018]

**ONE SUPPLY TAPPING
FOR 3 AND 4 - SECTION BOILERS ONLY**

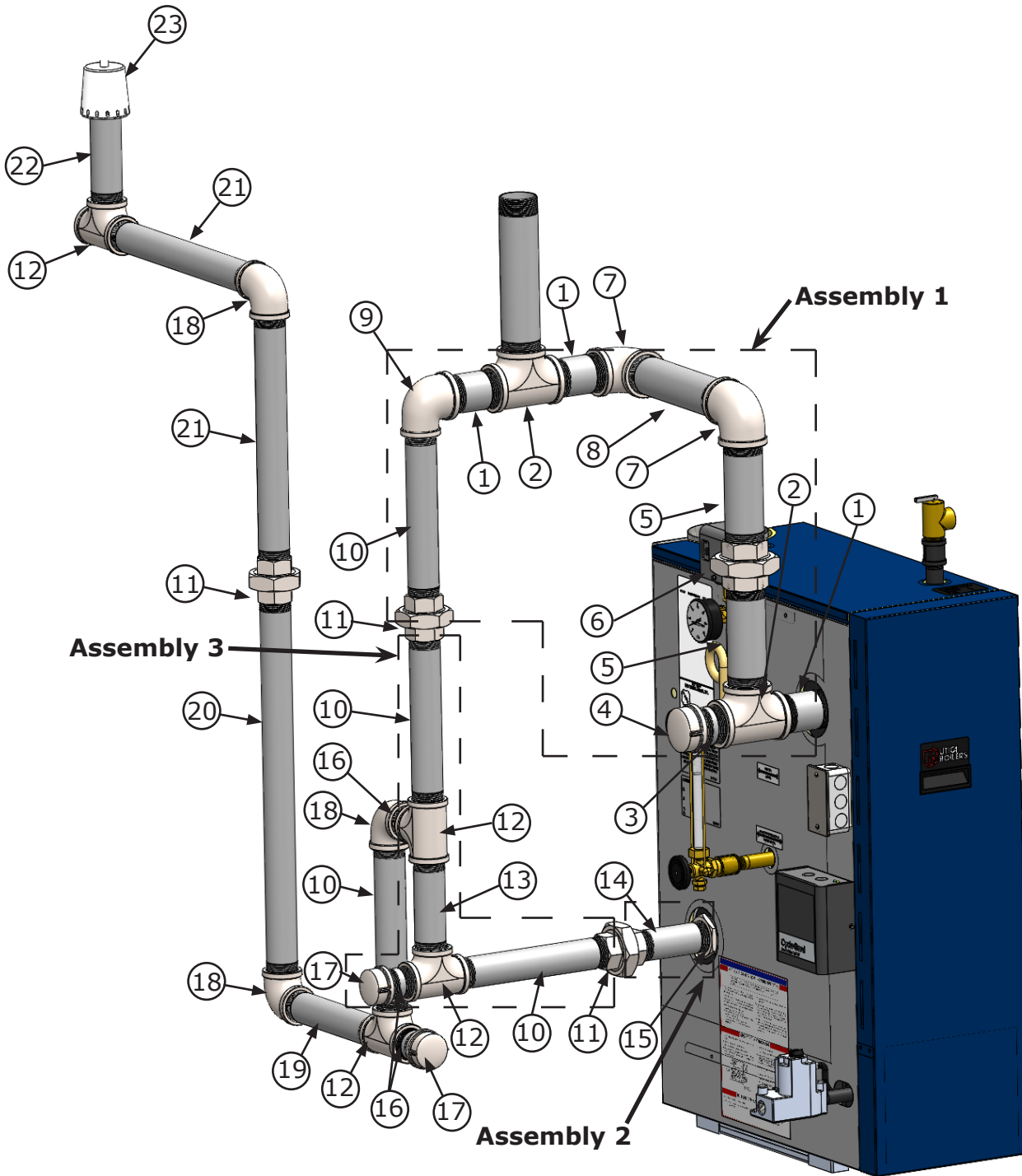

- All installations shall follow National/Local codes and requirements mentioned in boiler installation manual.
- It is recommended to apply Teflon tape and quality pipe dope on all threaded connections.
- Engagement depth for all piping is normally around $1\frac{1}{32}$ " per threaded connection.
- Engagement depth of threaded connection depends on quality and supplier of parts. Installer is responsible for making sure each connection is fully engaged, secure, and leak free.

ONE SUPPLY TAPPING - LIST OF PARTS

Piping			
Item #	Description	Length	Quantity Required
1	2" NPT,Nipple	4"	3
2	2" NPT,Tee Connector	n/a	2
3	2" NPT,Nipple	2 ½"	1
4	2" NPT,Cap	n/a	1
5	2" NPT,Nipple	5"	2
6	2" NPT,Union	n/a	1
7	2" NPT,Elbow Connector	n/a	2
8	2" NPT,Nipple	10"	1
9	2" to 1 ½" NPT,Elbow Reducer	n/a	1
10	1 ½" NPT,Nipple	11"	4
11	1 ½" NPT,Union	n/a	3
12	1 ½" NPT,Tee	n/a	4
13	1 ½" NPT,Nipple	6 ½"	1
14	1 ½" NPT,Nipple	5 ½"	1
15	2"-1 ½" Bushing Reducer	n/a	1
16	1 ½" NPT,Close Nipple	1 ¾"	3
17	1 ½" NPT,Cap	n/a	2
18	1 ½" NPT,Elbow	n/a	3
19	1 ½" NPT,Nipple	10"	1
20	1 ½" NPT,Nipple	24"	1
21	1 ½" NPT,Nipple	16"	2
22	1 ½" NPT,Nipple	7"	1
23	Air Vent	n/a	1

ONE SUPPLY TAPPING - ASSEMBLY PROCEDURE

- Assembly 1

1. Secure Pipe 1 to boiler
2. Tee 2 to pipe 1
3. Pipe 3 to tee 2
4. Cap 4 to pipe 3
5. Pipe 5 to tee2
6. Union 6 to pipe 5
7. Pipe 5 onto other side of union 6
8. Elbow 7 to pipe 5
9. Pipe 8 to elbow 7
10. Elbow 7 to pipe 8
11. Pipe 1 to elbow 7
12. Tee 2 to pipe 1
13. Pipe 1 to tee 2
14. Elbow reducer 9 to pipe 1
15. Pipe 10 to elbow reducer 9
16. Half of union 11 to pipe 10

- Assembly 2

1. Secure Reducer 15 to boiler
2. Pipe 14 to reducer 15
3. Half of union 11 to 14

- Assembly 3

1. Half of union 11 to pipe 10
2. Tee 12 to pipe 10
3. Pipe 13 to tee tee12
4. Tee 12 to pipe 13
5. Pipe 16 to tee 12
6. Cap 17 to pipe 16
7. Pipe 10 to tee 12
8. Half of Union 11 to pipe 10

- Attach assembly 3 to both assembly 1 & 2

- Finish near boiler piping

1. Pipe 16 to tee 12 from assy 2
2. Elbow 18 to pipe 16
3. Pipe 10 to pipe 18
4. Tee 12 to pipe 10
5. pipe 16 to tee 12
6. Cap 17 to pipe 16
7. Pipe 19 to tee 12
8. Elbow 18 to pipe 19
9. Pipe 20 to elbow 18
10. Union 11 to pipe 20
11. Pipe 21 to union 11
12. Elbow 18 to pipe 20
13. Pipe 21 to elbow 18
14. Tee 12 to pipe 21
15. Pipe 22 to tee 12
16. Air Vent 23 to pipe 22

TWO SUPPLY TAPPING

APPLICABLE FOR ALL MODELS. REQUIRED FOR 5 SECTION OR LARGER BOILERS

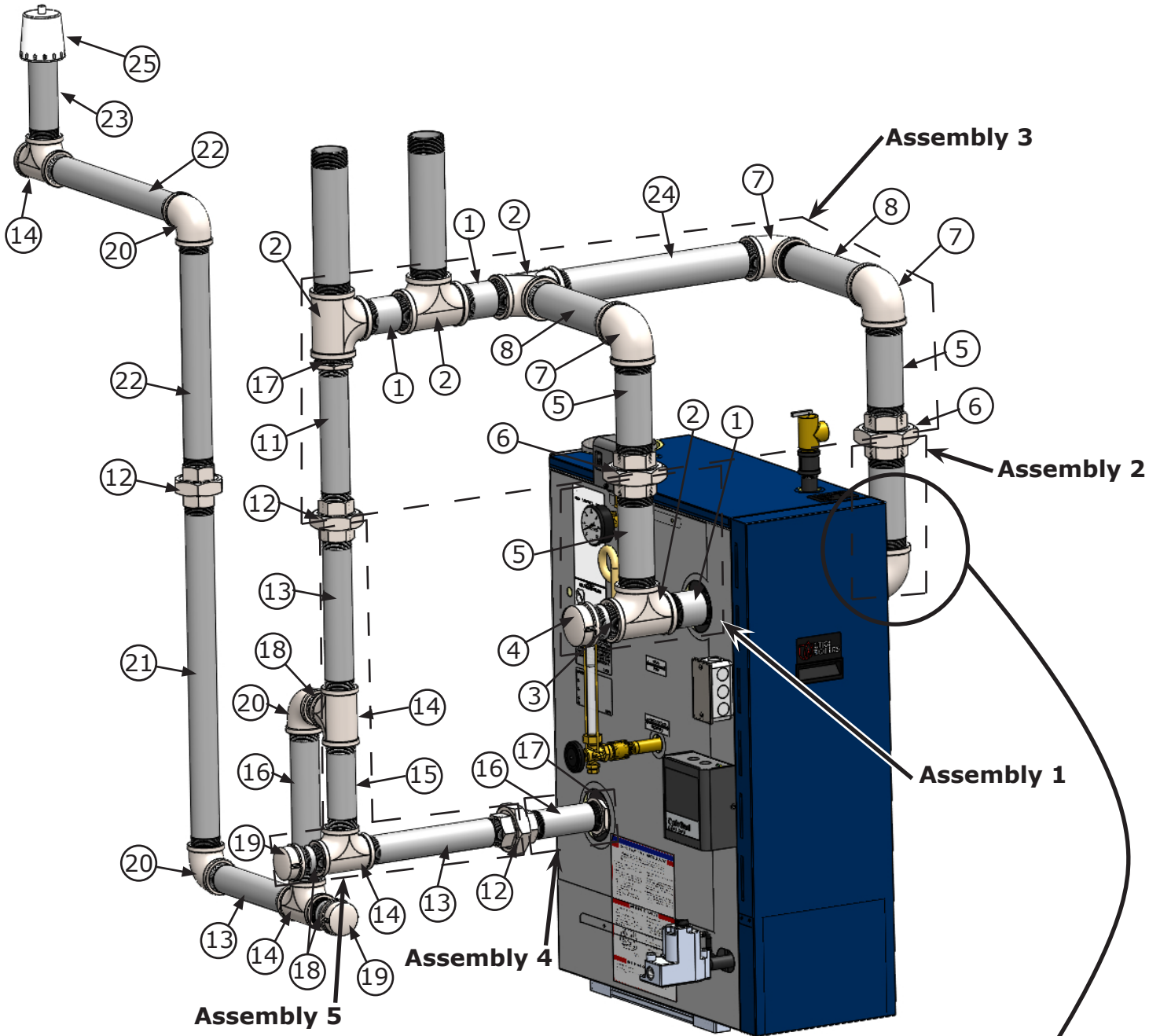

- All installations shall follow National/Local codes and requirements mentioned in boiler installation manual.
- It is recommended to apply Teflon tape and quality pipe dope on all threaded connections.
- Engagement depth for all piping is normally around $1\frac{9}{32}$ " per threaded connection.
- Engagement depth of threaded connection depends on quality and supplier of parts. Installer is responsible for making sure each connection is fully engaged, secure, and leak free.

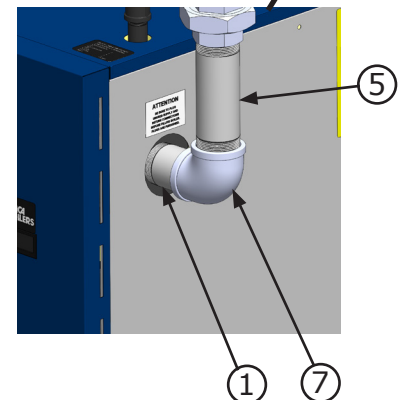

TWO SUPPLY TAPPING - LIST OF PARTS

Item #	Description	Length	Quantity Required
1	2" NPT,Nipple	4"	4
2	2" NPT,Tee Connector	n/a	4
3	2" NPT,Nipple	2 ½"	1
4	2" NPT,Cap	n/a	1
5	2" NPT,Nipple	5"	4
6	2" NPT,Union	n/a	2
7	2" NPT,Elbow Connector	n/a	4
8	2" NPT,Nipple	10"	2
11	1 ½" NPT,Nipple	10"	1
12	1 ½" NPT,Union	n/a	3
13	1 ½" NPT,Nipple	11"	3
14	1 ½" NPT,Tee	n/a	4
15	1 ½" NPT,Nipple	6 ½"	1
16	1 ½" NPT,Nipple	6"	2
17	2"-1 ½" Bushing Reducer	n/a	2
18	1 ½" NPT,Close Nipple	1 ¾"	3
19	1 ½" NPT,Cap	n/a	2
20	1 ½" NPT,Elbow	n/a	3
21	1 ½" NPT,Nipple	24"	1
22	1 ½" NPT,Nipple	16"	2
23	1 ½" NPT,Nipple	7"	1
24	2" NPT,Nipple	3 Sec - 16" 4 Sec - 19" 5 Sec - 22 ½" 6 Sec - 26" 7 Sec - 29" 8 Sec - 32" 9 Sec - 35 ½"	1
25	Air Vent	n/a	1

TWO SUPPLY TAPPING - ASSEMBLY PROCEDURE

- Assembly 1

1. Secure Pipe 1 to boiler
2. Tee 2 to pipe 1
3. Pipe 3 to tee 2
4. Cap 4 to pipe 3
5. Pipe 5 to tee 2
6. Half of union 6 to pipe 5

- Assembly 2

1. Secure Pipe 1 to boiler
2. Elbow 7 to pipe 1
3. Pipe 5 to elbow 7
4. Half of union 6 to pipe 5

- Assembly 3

1. Half of Union 6 to pipe 5
2. Pipe 5 to half of union 6
3. Elbow 7 to pipe 5
4. Pipe 8 to elbow 7
5. Tee 2 to pipe 8
6. Pipe 24 to tee 2
7. Elbow 7 to pipe 24
8. Pipe 8 to elbow 7
9. Elbow 7 to pipe 8
10. Pipe 5 to elbow 7
11. Half of Union 6 to pipe 5
12. Pipe 1 to tee 2
13. Tee 2 to pipe 1
14. Pipe 1 to tee 2
15. Tee 2 to pipe 1
16. Reducer bushing 17 to tee 2
17. Pipe 11 to bushing 17
18. Half of union 12 to pipe 11

- Attach assembly 3 to both assembly 1 & 2

- Assembly 4

1. Secure Reducer 17 to boiler
2. Pipe 16 to reducer 17
3. Half of union 12 to pipe 16

- Assembly 5

1. Half of union 12 to pipe 13
2. Tee 14 to pipe 13
3. Pipe 15 to tee 14
4. Tee 14 to pipe 15
5. Pipe 18 to tee 14
6. Cap 19 to pipe 18
7. Pipe 13 to tee 14
8. Half of Union 12 to pipe 13

- Attach assembly 5 to both assembly 3 & 4

- Finish near boiler piping

1. Pipe 18 to tee 14 from assy 5
2. Elbow 20 to pipe 18
3. Pipe 16 to elbow 20
4. Tee 14 to pipe 16
5. Pipe 18 to tee 14
6. Cap 19 to pipe 18
7. Pipe 13 to tee 14
8. Elbow 20 to pipe 13
9. Pipe 21 to elbow 20
10. Union 12 to pipe 21
11. Pipe 22 to union 12
12. Elbow 20 to pipe 22
13. Pipe 22 to elbow 20
14. Tee 14 to pipe 22
15. Pipe 23 to tee 14
16. Air Vent 25 to pipe 23



2201 Dwyer Avenue, Utica, NY 13501

Tel. 800 253 7900

www.ecrinternational.com

All specifications subject to change without notice.

©2018 ECR International, Inc.